



Towbar Fitting Instructions
To Suit VX Commodore
Sedan & Wagon 10/00 TO 07-06.
Part Number HD60AL
Rating 1600Kg

1. Remove the bumper bar, the bumper stiffener and stiffener brackets. Retain the four M12 nuts from the stiffener brackets.
2. From under the vehicle remove the rear nut securing the centre fuel tank bracket and discard nut. Offer the forward mounting bracket to the vehicle, loosely secure using M10 x 1.5p nuts and spring washers (Items 1, 2 and 3) forward most, ensure the fuel tank bracket is returned to its original position
3. Loosely secure using M10 x 1.5p nuts, spring washers and flat washers (Items 1, 2, 3 and 4) rear most.
4. Offer towbar to vehicle, refit bumper stiffener brackets and loosely secure using, 12mm spring washer (Item 5), and existing M12 nuts.
5. Secure forward mounting bracket to towbar with ½" x 1 ¼" unc bolt, flat washer, spring washer and ½" unc nut (Items 6, 7, 8 and 9).
6. Tighten all bolts to the correct settings as listed below.
7. Refit bumper stiffener and bumper bar.
8. Attach the tongue (item 12) to the towbar using (items 10 & 11). Torque the bolts to the correct setting.

COMPONENT KIT

| ITEM No. | DESCRIPTION | QTY | TORQUE Nm |
|-----------------|--------------------------|------------|------------------|
| 1 | Forward Mounting Bracket | 1 | |
| 2 | M10 x 1.5p nut | 3 | 44 |
| 3 | 10mm spring washer | 3 | |
| 4 | 3/8" flat washer | 2 | |
| 5 | 12mm spring washer | 4 | |
| 6 | ½" x 1 ¼" unc bolt | 1** | 125 |
| 7 | ½" flat washer | 1 | |
| 8 | ½" spring washer | 1 | |
| 9 | ½" unc nut | 1** | |
| 10 | 5/8" x 1 ¾" unc bolt | 2* | 249 |
| 11 | 5/8" spring washer | 2* | |
| 12 | Tongue, PHD60 | 1 | |

Note: * One of each item 10 and 11 is used to secure the tongue to the towbar during transit. Note: ** Item 6 and 9 is used to secure the Forward Mounting Bracket to the towbar during transit.

Towbar Fitting Instructions
To Suit VX Commodore
Sedan & Wagon 10/00 TO 07-06.
Part Number HD60AL
Rating 1600Kg

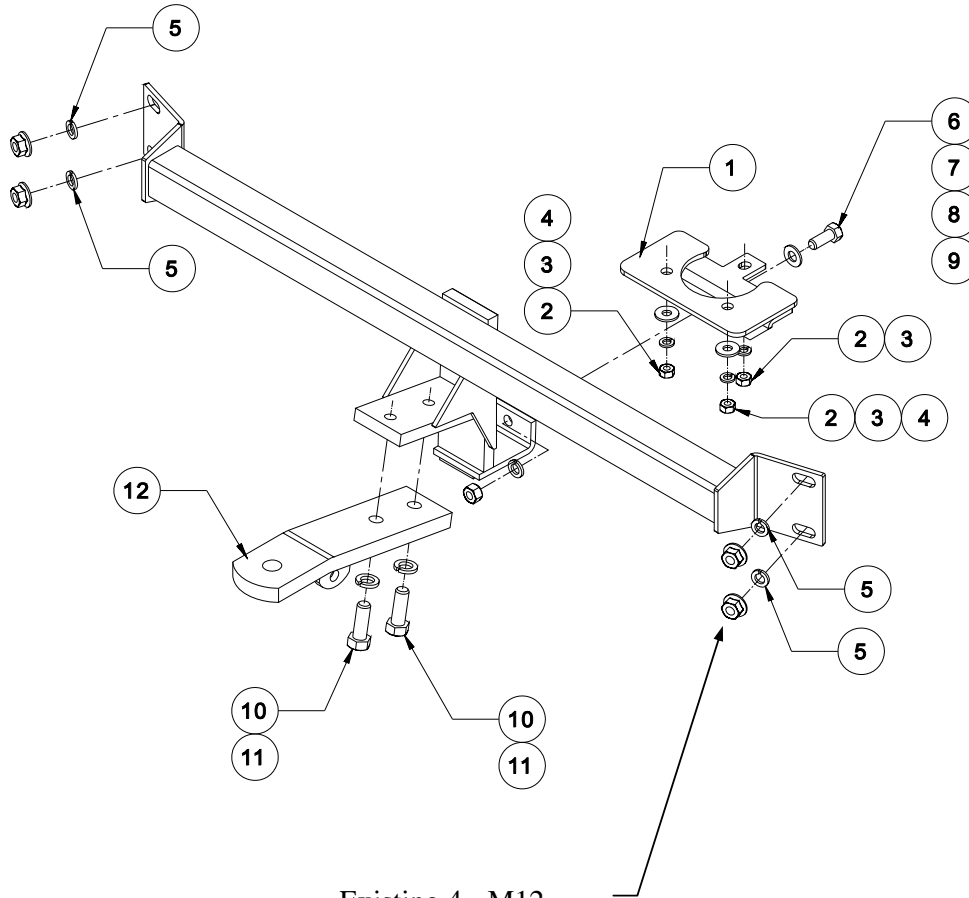

Existing 4 - M12
nuts removed in
Step 1



Wiring Loom Fitting Instructions
To Suit Holden Commodore – VT to VZ
Part Number 100044-WL

Wiring Loom Installation Instructions

Holden Commodore – VT to VZ

Part No: 100044-WL

Tail Harness Length Required: 1200mm

RPA Override Switch Part No: 04848 (If Fitted)

Wiring Loom Installation Time: Approx 20 Mins

Sedan – Page 2

Wagon – Page 4

Crewman – Page 5

Wiring Loom Fitting Instructions To Suit Holden Commodore – VT to VZ Part Number 100044-WL

The following steps are for Sedan models only. For Wagon models please proceed to Page 4. For Crewman models please proceed to Page 5.

1. In the luggage compartment, remove all trims required to gain access to the tail lights.
2. Remove the rear bumper fascia fasteners and then remove the rear bumper fascia (1).
3. Drill a Ø30mm grommet hole into the location shown (2). File down any rough edges and spray on rust inhibitor.

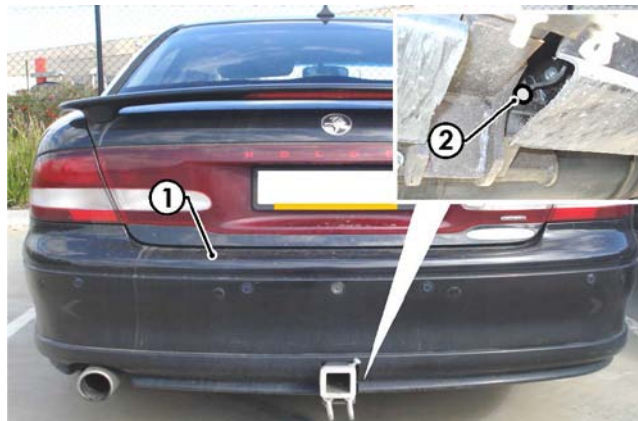

4. Mount the Tail Harness socket (Tail length 1200mm) to the towbar mounting bracket using M4 fasteners.
5. Route the harness along the towbar and into the grommet hole.
6. In the luggage compartment, retrieve the Tail Harness.
7. Adjust the harness grommet to the desired position, ensuring that it is seated correctly into the vehicle grommet hole. Secure the vehicle grommet using a cable tie (not supplied).
8. On the outside of the vehicle, secure the harness to the towbar using cable ties (not supplied).
9. Disconnect the RHS tail light connectors and the 1-way indicator connector. Connect the Trailer Patch Harness (P/No: 100044-WL) in between the tail light connectors and the 1-way indicator connector.
10. Connect the Tail Harness 8-Way male connector to the Trailer Patch Harness 8-Way female connector.
11. Re-fit the rear bumper fascia.



Wiring Loom Fitting Instructions
To Suit Holden Commodore – VT to VZ
Part Number 100044-WL

12. Test the Trailer socket using a light board or multimeter.
13. Secure all the harnesses using cables ties (not supplied).
14. Re-fit all removed parts and secure all fasteners, ensuring there are no squeaks or rattles.
15. Place instructions in glove box after fitment.



Wiring Loom Fitting Instructions
To Suit Holden Commodore – VT to VZ
Part Number 100044-WL

The following steps are for Wagon vehicles only. For Sedan vehicles please refer to Page 2. For Crewman models please proceed to Page 5.

1. Remove the rear bumper fascia.
2. Gain access to the tail lights.
3. Remove the tail light assembly.
4. Drill a Ø30mm hole into the rear tail gate, below the RHS tail light cavity opening. File down any rough edges and spray on rust inhibitor.
5. Mount the Tail Harness socket (Tail length 1200mm) to the towbar mounting bracket using M4 fasteners.
6. Route the Tail Harness along the towbar and into the grommet hole
7. Adjust the harness grommet to the desired position, ensuring that it is seated correctly into the vehicle grommet hole. Secure the vehicle grommet using a cable tie (not supplied).
8. Secure the harness to the towbar using cable ties (not supplied).
9. Disconnect the RHS tail light connectors and the 1-way indicator connector. Connect the Trailer Patch Harness (P/No: 100044-WL) in between the tail light connectors and the 1-way indicator connector
10. Connect the Tail Harness 8-way male connector to the Trailer Patch Harness 8-way female connector.
11. Test the Trailer Harness function using a Light Board or multimeter.
12. Secure the Trailer Patch Harness using cable ties (not supplied).
13. Re-fit all removed parts and secure all fasteners, ensuring there are no squeaks or rattles.
14. Place the instructions in the glove box after fitment.



Wiring Loom Fitting Instructions
To Suit Holden Commodore – VT to VZ
Part Number 100044-WL

The following steps are for Crewman vehicles only. For Sedan vehicles please refer to Page 2. For Wagon models please proceed to Page 4.

1. From the outside of the vehicle, dislodge the tub liner.
2. Remove the RHS access panel by first releasing the eight Phillips head screws.
3. Locate and disconnect the vehicle 6-Way connectors and connect the trailer patch (100044-WL) mating 6-Way connectors in between.
4. Connect the trailer patch 1-Way connector to the vehicle mating 1-Way connector.
5. Mount the trailer socket to the towbar mounting bracket using M4 fasteners (not supplied).
6. Route the tail harness (tail length 1200mm) along the towbar and towards the RHS of the vehicle.
7. Route the tail harness through the grommet hole behind the vehicle number plate.
8. Using a guide wire, route the tail harness 8-way connector up towards the trailer patch.
9. Connect the trailer patch 8-way connector to the tail harness mating 8-way connector.
10. Test the Trailer Harness function using a Light Board or multimeter.
11. Secure the Trailer Patch Harness using cable ties (not supplied).
12. Re-fit all removed parts and secure all fasteners ensuring, there are no squeaks or rattles.
13. Place the instructions in the glove box after fitment.